

1N4148W/BAV16W

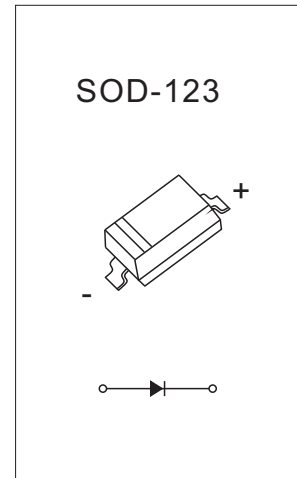

Fast Switching Diodes

FEATURES

- Fast switching speed
- Surface mount package ideally suited for automatic insertion
- For general purpose switching applications
- High conductance

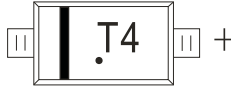
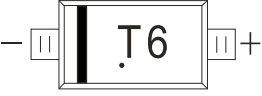

Marking: T4, T6

1N4148W	BAV16W
	
	

The marking bar indicates the cathode.
Solid dot = Green molding compound device, if none, the normal device.

MAXIMUM RATINGS(Ta=25°C)

Symbol	Parameter	Value	Unit
VRM	Non-Repetitive peak reverse voltage	100	V
VRRM	Peak repetitive peak reverse voltage	100	V
VRWM	Working peak		
VR	DC blocking voltage		
VR(RMS)	RMS reverse voltage	71	V
IFM	Forward continuous current	300	mA
IO	Average rectified output current	150	mA
IFSM	Non-repetitive Peak forward surge current @8.3mS	2	A
PD	Power dissipation	1N4148W	mW
		BAV16W	
RθJA	Thermal Resistance Form Junction to Ambient	250	°C/W
TJ	Junction Temperature	150	°C
TSTG	Storage Temperature Range	-55~+150	°C



1N4148W/BAV16W

ELECTRICAL CHARACTERISTICS(Ta=25°C)

Parameter	Symbol	Test Condition	Min.	Typ.	Max.	Units
Forward voltage	V _{F1}	I _{F1} =1.0mA			0.715	V
	V _{F2}	I _{F2} =10mA			0.855	V
	V _{F3}	I _{F3} =50mA			1.0	V
	V _{F4}	I _{F4} =150mA			1.25	V
Reverse current	I _{R1}	V _R =75V			1	uA
	I _{R2}	V _R =20V			25	nA
Capacitance between terminals	C _T	V _R =0V, f=1.0MHz			2	pF
Reverse recovery time	T _{rr}	I _F =I _R =10mA, I _{rr} =0.1X I _R , R _L =100Ω			4	ns



1N4148W/BAV16W

TYPICAL CHARACTERISTICS ($T_a=25^\circ\text{C}$)

Forward Characteristics

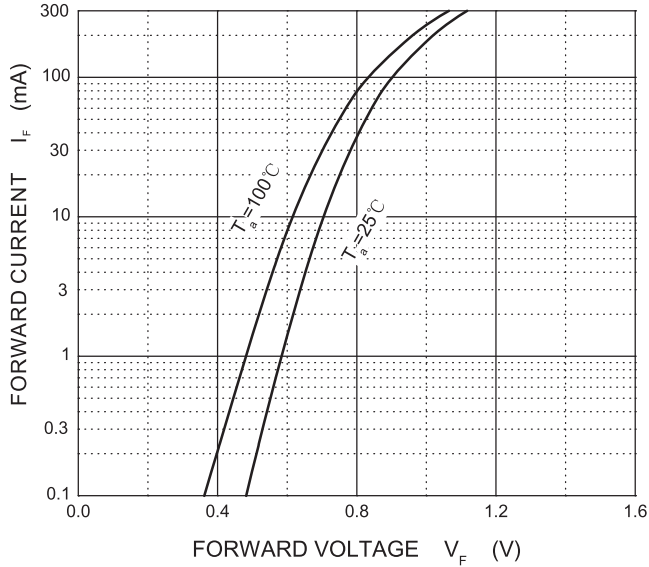

Reverse Characteristics

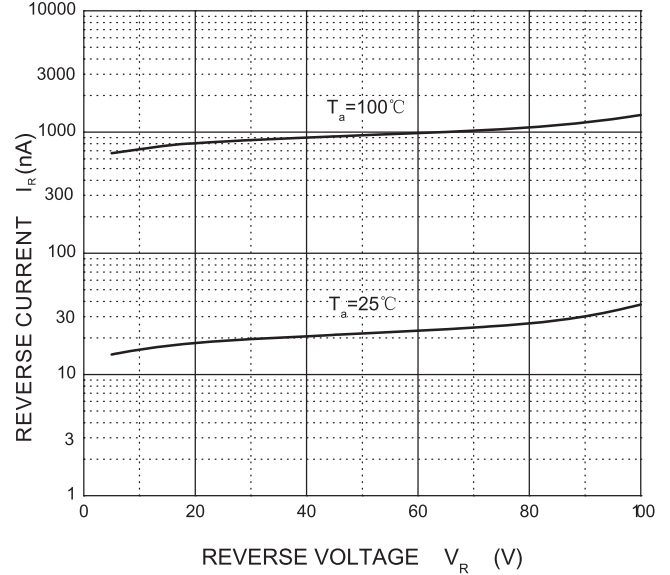

Capacitance Characteristics

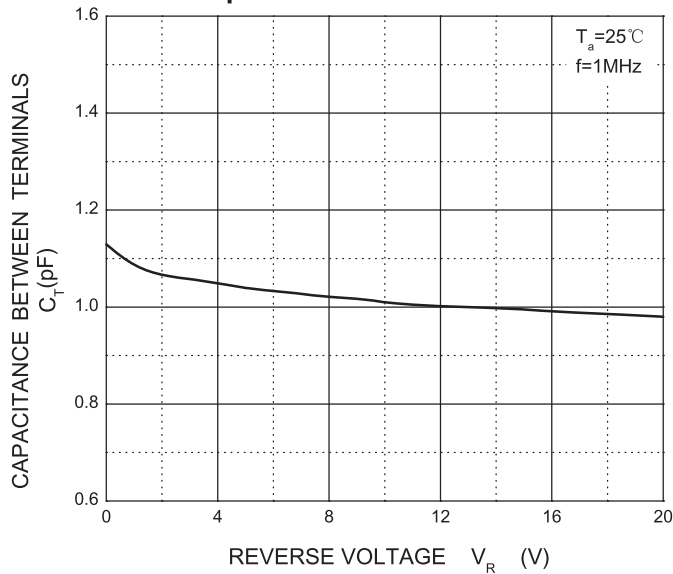

Power Derating Curve

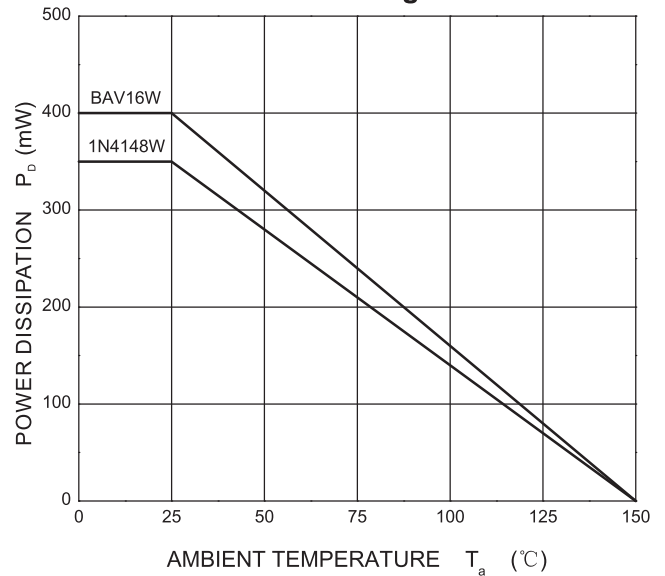



SOD-123 Package Outline Dimensions

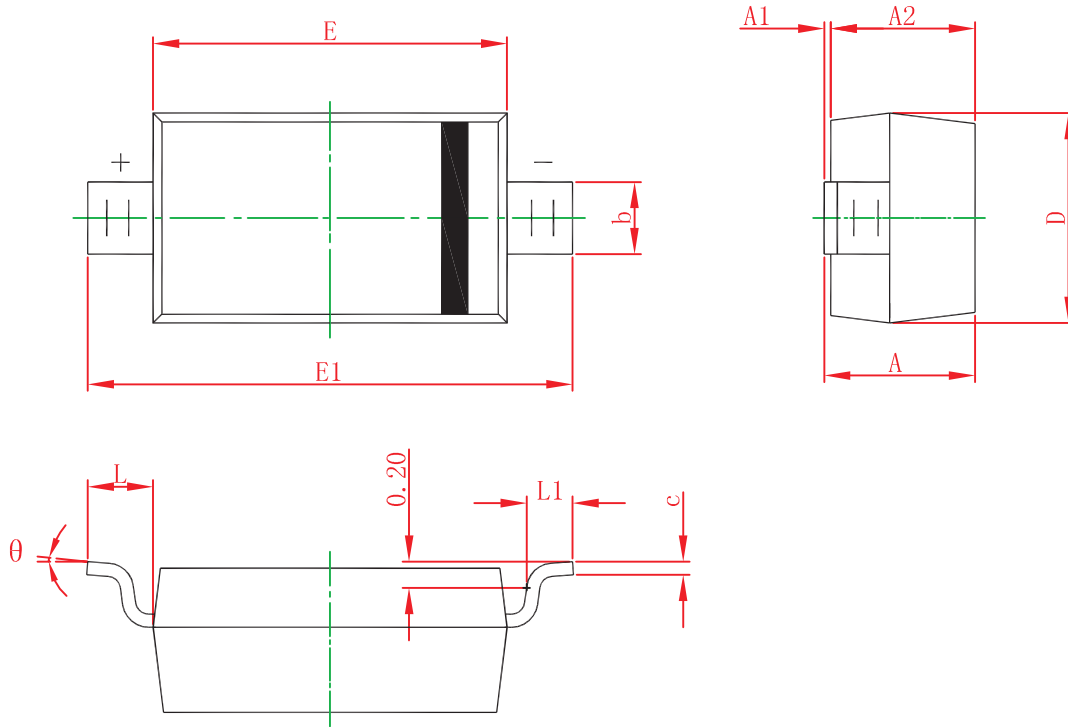

Symbol	Dimensions In Millimeters		Dimensions In Inches	
	Min.	Max.	Min.	Max.
A	1.050	1.250	0.041	0.049
A1	0.000	0.100	0.000	0.004
A2	1.050	1.150	0.041	0.045
b	0.450	0.650	0.018	0.026
c	0.080	0.150	0.003	0.006
D	1.500	1.700	0.059	0.067
E	2.600	2.800	0.102	0.110
E1	3.550	3.850	0.140	0.152
L	0.500 REF.		0.020 REF.	
L1	0.250	0.450	0.010	0.018
θ	0°	8°	0°	8°



SOD-123 Tape and reel

SOD-123 Embossed Carrier Tape

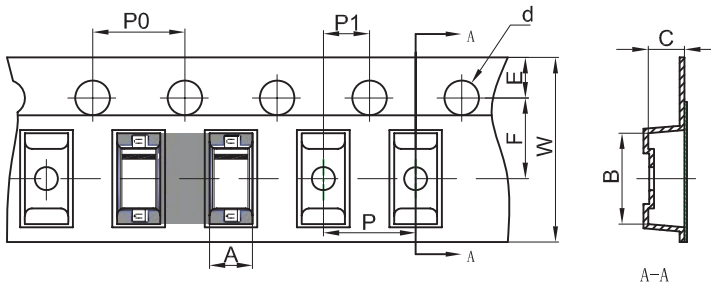

Packaging Description:

SOD-123 parts are shipped in tape. The carrier tape is made from a dissipative (carbon filled) polycarbonate resin. The cover tape is a multilayer film (Heat Activated Adhesive in nature) primarily composed of polyester film, adhesive layer, sealant, and anti-static sprayed agent. These reeled parts in standard option are shipped with 3,000 units per 7" or 17.8cm diameter reel. The reels are clear in color and is made of polystyrene plastic (anti-static coated).

Dimensions are in millimeter										
Pkg type	A	B	C	d	E	F	P0	P	P1	W
SOD-123	1.85	3.94	1.57	Ø1.55	1.75	3.50	4.00	4.00	2.00	8.00
(Tolerance)	+/-0.05	+/-0.05	+/-0.05	+/-0.1	+/-0.1	+/-0.1	+/-0.1	+/-0.1	+/-0.1	+0.3/-0.1

SOD-123 Tape Leader and Trailer

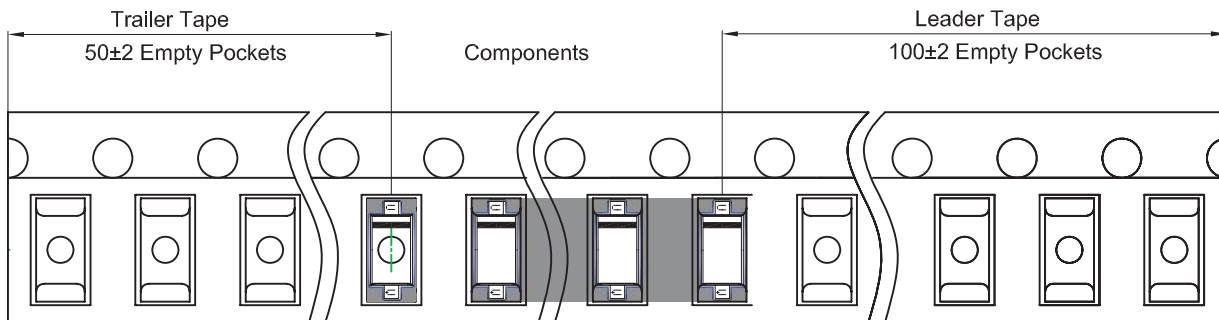

SOD-123 Reel

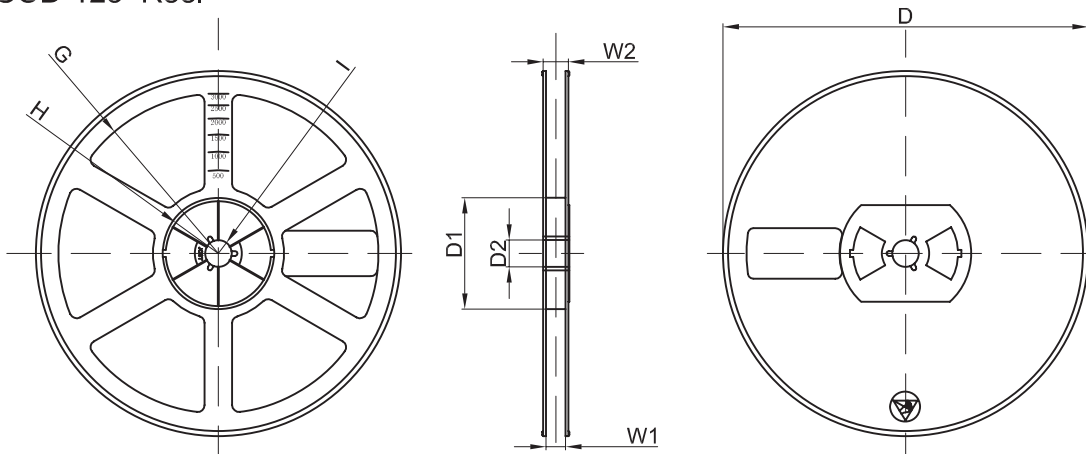

Dimensions are in millimeter								
Reel Option	D	D1	D2	G	H	I	W1	W2
7" Dia	Ø178.00	54.40	13.00	R78.00	R25.60	R6.50	9.50	12.30
Tolerance	+/-2	+/-1	+/-1	+/-1	+/-1	+/-1	+/-1	+/-1

REEL	Reel Size	Box	Box Size(mm)	Carton	Carton Size(mm)	G.W.(kg)
3000 pcs	7 inch	45,000 pcs	203×203×195	180,000 pcs	438×438×220	



SOD-123 Suggested Pad size

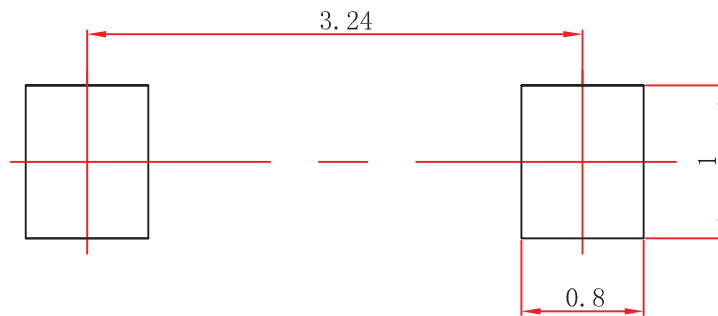

中心距：3.24

脚宽：0.55

焊盘宽：1

脚长：0.50

焊盘长：0.80

技术要求

1. 塑封体尺寸 2.70×1.60 ;
2. 未注公差为： ± 0.05 ;
3. 所有单位为：mm。

Unit: mm

ZOHE ELECTRONIC TECHNOLOGY PACKING PROCESS

